

It is possible as you are nearing the last few courses of an ICF wall installation you realize you may be running short on corner forms. Instead of waiting for the next shipment of blocks to arrive on-site potentially causing delays, a better option may be to create corner forms with Logix Standard forms.

With just a few simple cuts from two Standard forms corner forms can be easily made on-site.

Start with two Standard forms and cut one of the forms in half, or as needed to ensure the corners will butt up against adjoining forms.

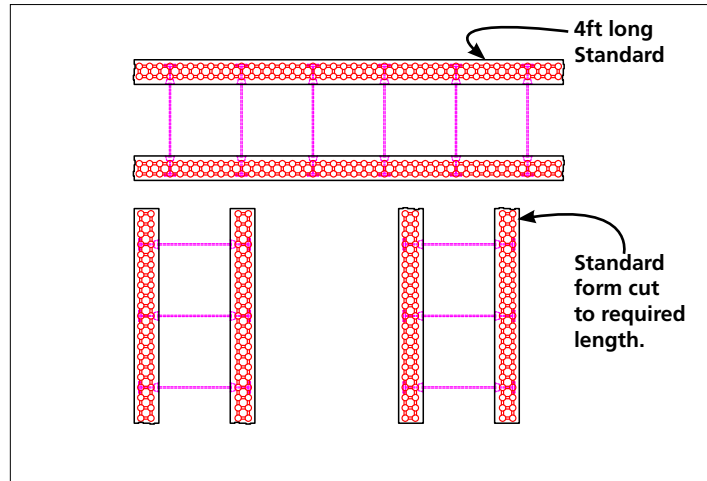

Cut the shaded sections shown using the forms as a cutting guide.

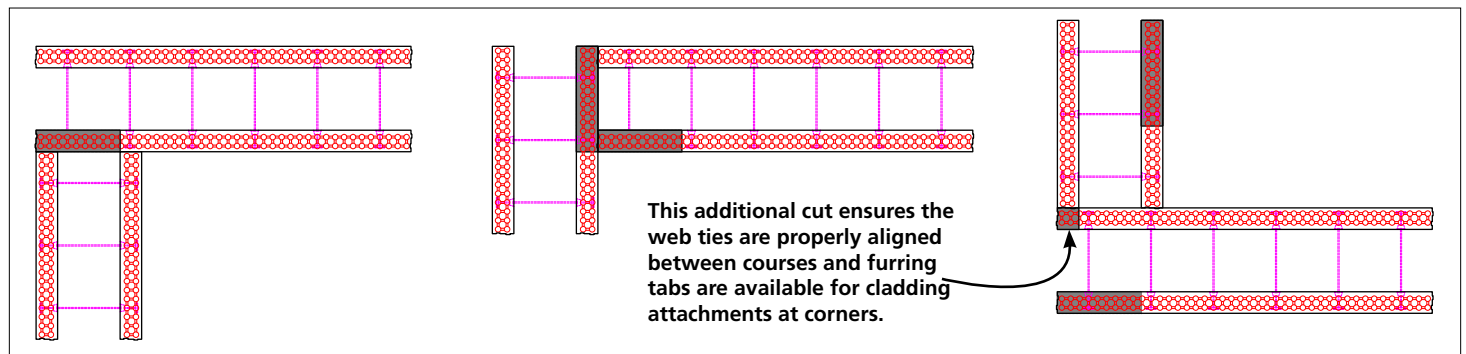

Install the cut forms. Temporarily secure the corner forms with construction tape.

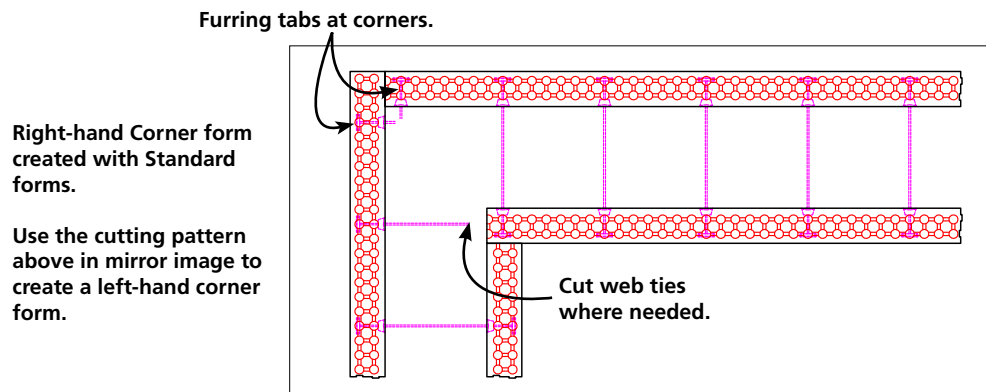

Use the remaining cut piece of the Standard form to create the corner for the next course. Repeat the above cutting pattern in a mirror image to ensure the corner joints are staggered.

Provide additional corner form support after installing the bracing and alignment system. The illustration below shows form support for a full height wall. If corner forms made with Standards are only needed for the last few courses wood strapping may be all that's needed.

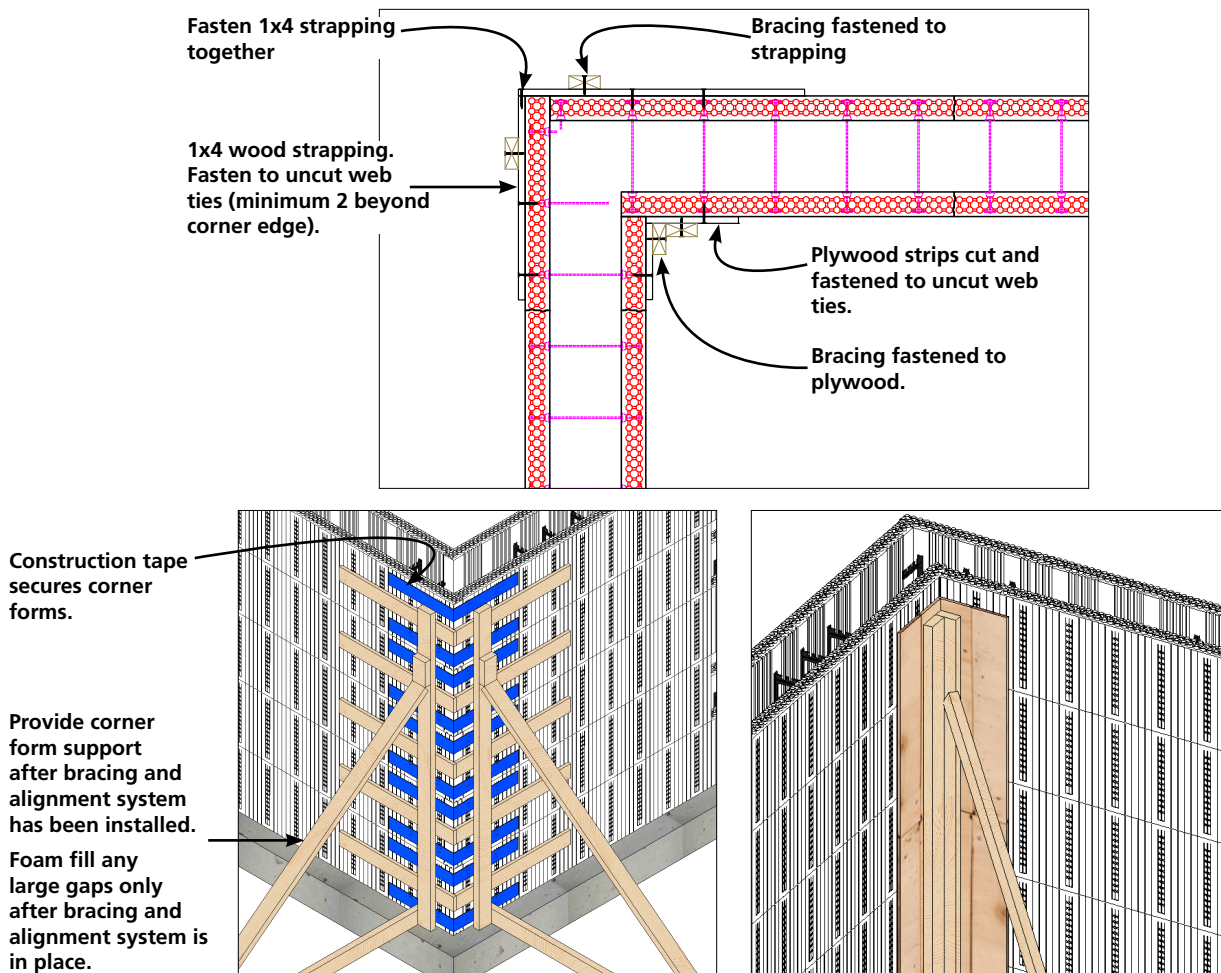

NOTES:

1. The above drawings illustrate an example of wall bracing. The builder should use sound judgment based on wall structure, pouring sequence and other site conditions, to determine if additional form support and bracing is required.
2. Avoid placing concrete directly into the corners.
3. Follow all required national and local wall brace safety regulations.