

PLAN VIEW

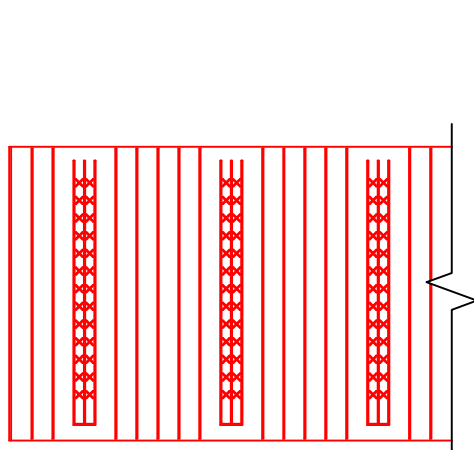

SIDE ELEVATION

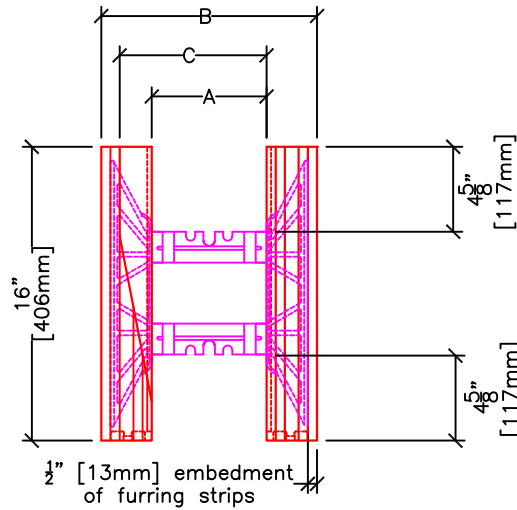

END VIEW

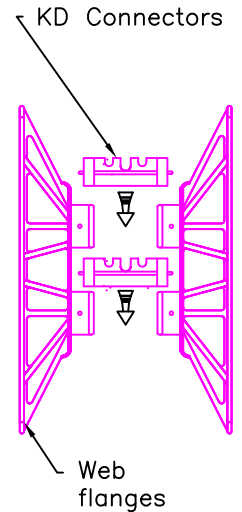

WEB COMPONENTS (NTS)

	FORM SIZES, in (mm)				
	4 (102)	6.25 (159)	8 (203)	10 (254)	12 (305)
Dimension A, in (mm)	n/a	6.25 (159)	8 (203)	10 (254)	12 (305)
Dimension B, in (mm)	n/a	11.75 (298)	13.5 (343)	15.5 (394)	17.5 (445)
Dimension C, in (mm)	n/a	8 (203)	9.75 (248)	11.75 (298)	13.75 (349)
Conc. Vol. (y ³)	n/a	0.124	0.152	0.185	0.218
Conc. Vol. (ft ³)	n/a	3.339	4.116	5.005	5.894
Conc. Vol. (m ³)	n/a	0.095	0.117	0.142	0.167
Wall Area (sf)	n/a	5.333	5.333	5.333	5.333
R-value	n/a	21.5	21.6	21.7	21.8
RSI	n/a	3.78	3.80	3.82	3.84

NOTES:

1. Wall area per block or panel = 5.333 ft²
2. Forms are available as assembled (LOGIX PRO) or unassembled (or knock-down) form blocks (LOGIX KD Product drawings).
3. Concrete core thickness wider than 12" (305mm) are available using LOGIX Xtenders (See Logix Xtender Product drawing).
4. 6 1/4" [159mm] LOGIX Form shown.



www.logixcf.com
1-866-944-0153

The drawing represented herein is to be used as a reference guide only; the user shall check to ensure the drawing meets local building codes and construction practices by consulting local building officials and professionals, including any additional requirements. Logix reserves the right to make changes to the drawing without notice and assumes no liability in connection with the use of the drawing including modification, copying or distribution.

Drawing:
5.1.18.6

Date:
Dec 24/16

Title:

KD TAPER TOP FORMS