

**NOTES:**

1. Size of frost wall applies to Logix 6.25", 8", 10" and 12" ICFs (concrete core thickness)
2. Above-grade wall applies to light-frame construction complying with Part 9 of the National Building Code of Canada.
3. Provide double mat rebar for 12" Logix with minimum  $\frac{3}{4}$ " concrete cover to vertical bars.
4. Visit Heat-Sheet.com for more information on Heat-Sheet radian floor insulation panels.

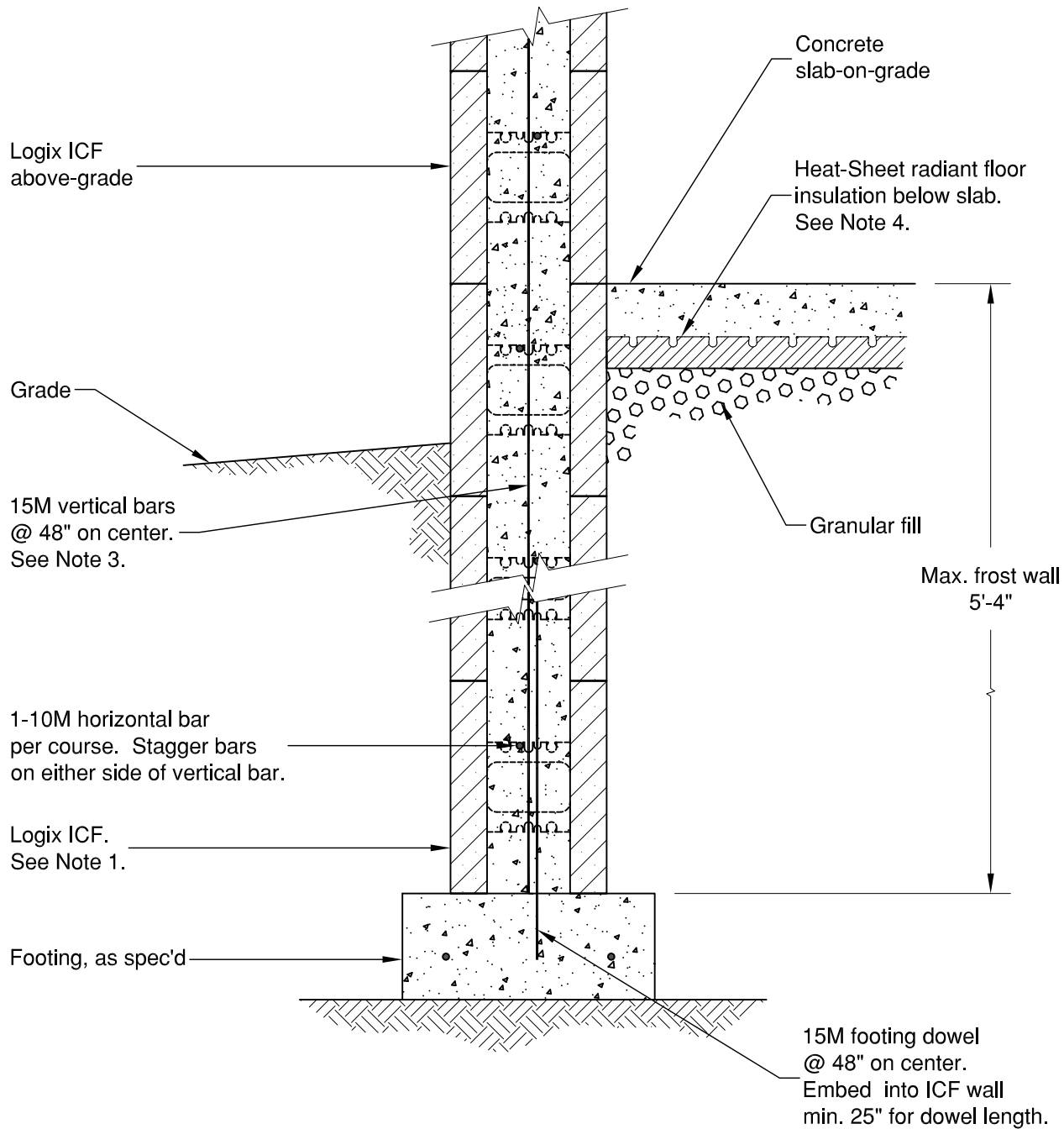

**NOTES:**

1. Size of frost wall applies to Logix 6.25", 8", 10" and 12" ICFs (concrete core thickness)
2. Above-grade wall applies to Logix ICF complying with Section 6, Engineering, of the Logix Design Manual. Maximum above-grade wall size is equal to size of frost wall.
3. Provide double mat rebar for 12" Logix frost walls with minimum  $\frac{3}{4}$ " concrete cover to vertical bars.
4. Visit Heat-Sheet.com for more information on Heat-Sheet radian floor insulation panels.