

NOTES:

See Section 6 – Engineering in the LOGIX Product Manual for reinforcement details.

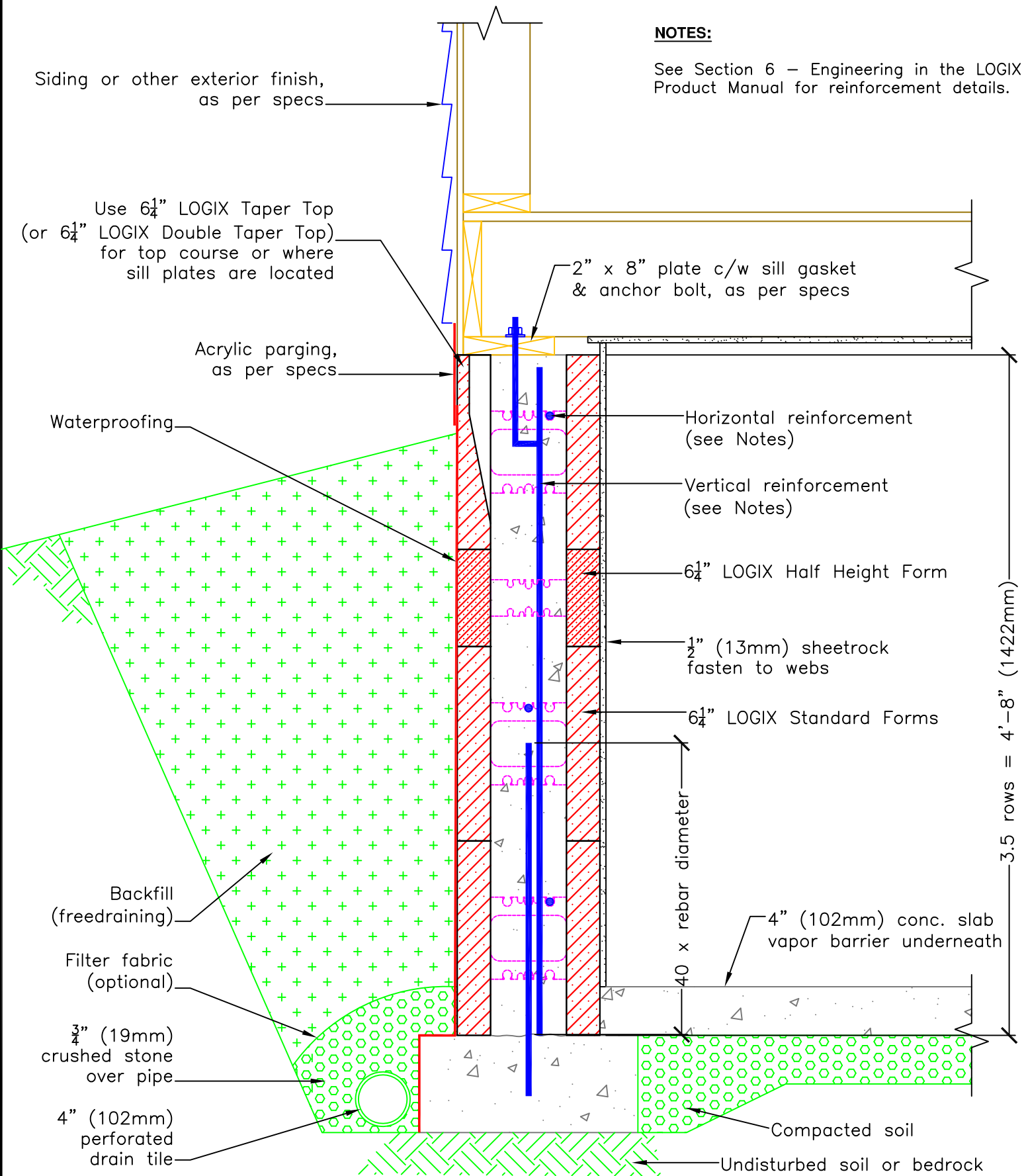

Siding or other exterior finish, as per specs

Use 6 1/4" LOGIX Taper Top (or 6 1/4" LOGIX Double Taper Top) for top course or where sill plates are located

Acrylic parging, as per specs

Waterproofing

Backfill (freedrainage)

Filter fabric (optional)

3/4" (19mm) crushed stone over pipe

4" (102mm) perforated drain tile

Horizontal reinforcement (see Notes)

Vertical reinforcement (see Notes)

6 1/4" LOGIX Half Height Form

1/2" (13mm) sheetrock fasten to webs

6 1/4" LOGIX Standard Forms

40 x rebar diameter

4" (102mm) conc. slab vapor barrier underneath

Compacted soil

Undisturbed soil or bedrock

3.5 rows = 4'-8" (1422mm)



The drawing represented herein is to be used as a reference guide only; the user shall check to ensure the drawing meets local building codes and construction practices by consulting local building officials and professionals, including any additional requirements. Logix reserves the right to make changes to the drawing without notice and assumes no liability in connection with the use of the drawing including modification, copying or distribution.

Drawing: 5.3.2	Date: Jul 30/13
Title: 4'-8" (1422mm) FROST WALL (CRAWL SPACE)	