

**PLAN VIEW**

2 3/4" (70mm) panels

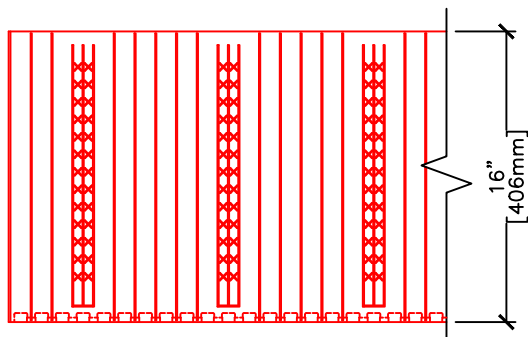

**SIDE ELEVATION**

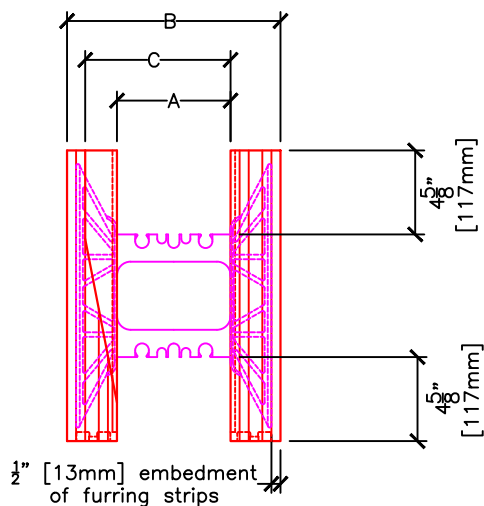

**END VIEW**

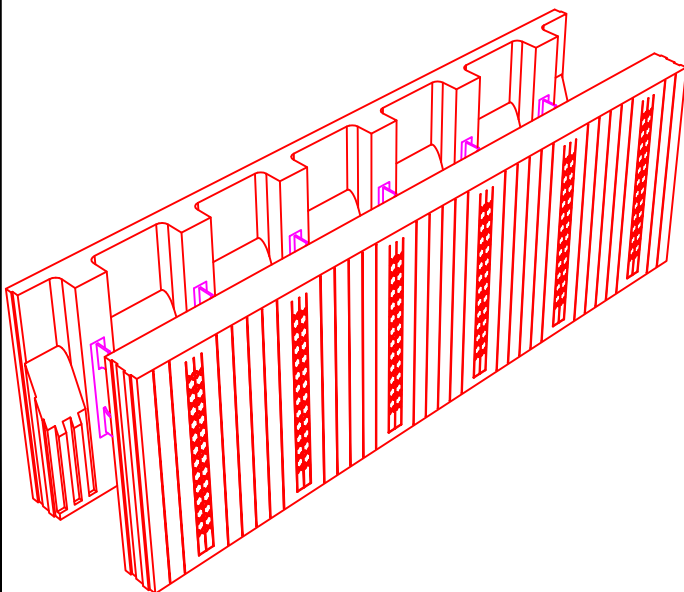

	FORM SIZES, in (mm)				
	4 (102)	6.25 (159)	8 (203)	10 (254)	12 (305)
Dimension A, in (mm)	4 (102)	6.25 (159)	8 (203)	10 (254)	12 (305)
Dimension B, in (mm)	9.5 (241)	11.75 (298)	13.5 (343)	15.5 (394)	17.5 (445)
Dimension C, in (mm)	5.75 (146)	8 (203)	9.75 (248)	11.75 (298)	13.75 (349)
Conc. Vol. (y <sup>3</sup> )	0.087	0.124	0.152	0.185	0.218
Conc. Vol. (ft <sup>3</sup> )	2.339	3.339	4.116	5.005	5.894
Conc. Vol. (m <sup>3</sup> )	0.066	0.095	0.117	0.142	0.167
Wall Area (sf)	5.333	5.333	5.333	5.333	5.333
R-value	21.3	21.5	21.6	21.7	21.8
RSI	3.76	3.78	3.80	3.82	3.84

**NOTES:**

1. Wall area per block or panel = 5.333 ft<sup>2</sup>
2. Forms are available as assembled (LOGIX PRO) or unassembled (or knock-down) form blocks (LOGIX KD Product drawings).
3. Concrete core thickness wider than 12" (305mm) are available using LOGIX Xtenders (See Logix Xtender Product drawing).
4. 6 1/4" [159mm] LOGIX Form shown.



The drawing represented herein is to be used as a reference guide only; the user shall check to ensure the drawing meets local building codes and construction practices, including any additional requirements. Logix reserves the right to make changes to the drawing without notice and assumes no liability in connection with the use of the drawing including modification, copying or distribution.

Drawing:  
5.1.1.3

Date:  
Dec 24/16

Title:

TAPER TOP FORMS